

RAIN HARVESTING

by Blue Mountain Co

Mozzie Stoppas Fixed Screen



Installation and Specification Guide

PRODUCT DETAILS

The original solution to preventing mosquitoes from entering your tank.

It simply presses into the overflow of your tank and the fine aperture stainless steel mesh prevents pests from entering.

Code	Size	Country
TATO61	50mm	Australia
TATO05	90mm	
TATO17	100mm	
TATO05	100mm	New Zealand
TATO17	100mm	
TATO17	100mm	UK
TATO17	100mm	South Africa
TATO17	100mm	India
TATO17	100mm	EU

Installation

WHAT'S IN THE BOX?

- Mozzie Stoppa Insect Proof Screen

TOOLS/MATERIALS YOU MAY REQUIRE

- Tape measure
- Marker pen
- Saw

INSTALLATION

1 - Select an installation point for your Mozzie Stoppa Fixed Screen. Generally speaking, this will be on your tank overflow outlet. Keep in mind that your Mozzie Stoppa Fixed Screen must be removable to allow for easy maintenance and cleaning so the mosquito-proof screen does not become clogged or blocked.

2 - To install, simply press your Mozzie Stoppa Fixed Screen into your tank overflow outlet.

3 - Insert your overflow pipe into the socket side of the Mozzie Stoppa Fixed Screen.

4 - It is important that the Mozzie Stoppa Fixed Screen is not glued to the outlet or overflow pipe for easy maintenance. For this reason, the Mozzie Stoppa Fixed Screen incorporates small raised sections in the socket and pipe to allow for easy removal.

Product Specifications

Mozzie Stoppas Fixed Screen

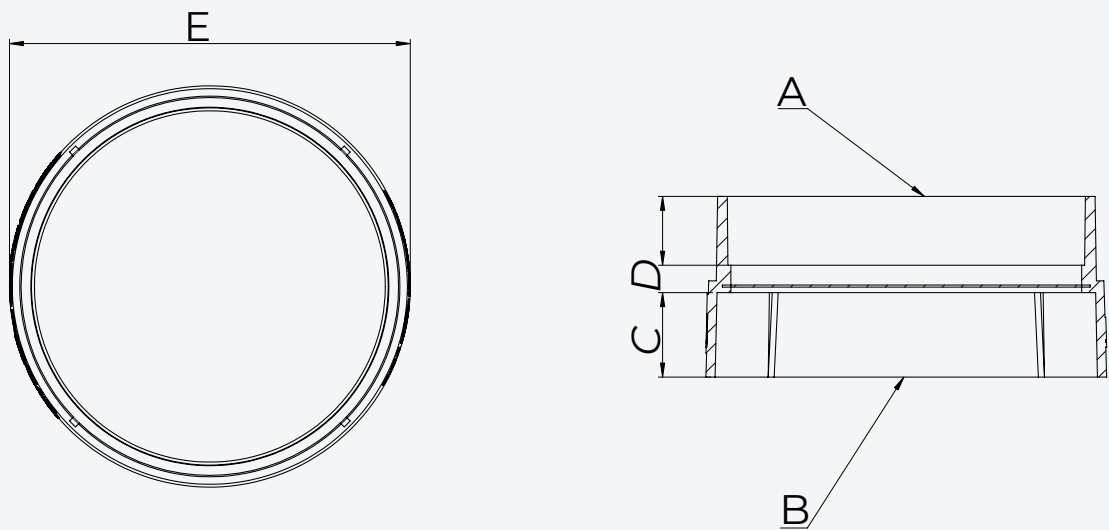

COUNTRY	CODE	A	B	C	D	E
Australia	TATO61	50 M	50 F	18	18	61
	TATO05	90 M	90 F	20	20	95
	TATO17	100 M	100 F	52	52	116
New Zealand	TATO05	100 M	100 F	52	52	116
	TATO17	100 M	100 F	52	52	116
UK, South Africa, India & EU	TATO17	110 M	100 F	52	52	116

All dimensions are in mm unless otherwise stated.

Fitting guide:
F = Female / Socket Fitting
M = Male / Spigot Fitting (Pipe size)
IP = In-Pipe Fitting

Maintenance

Remove your Mozzie Stoppa Fixed Screen from your tank overflow outlet and hose or otherwise clean the mosquito-proof screen. Replace the Mozzie Stoppa Fixed Screen immediately after cleaning by pressing it back into your tank overflow outlet.



A common misconception about collecting rainwater is that all you need is a roof, a tank and some rain. This 'tanking' approach cannot always be relied on to deliver the volume – or quality – of water that you require. That is where we can help.

With some thought, your rain harvesting system can provide you with cleaner water and lots of it. Whether you're completely reliant on tank water or wanting to keep the garden green, our simple steps will help you achieve your goal.

The Rain Harvesting approach to rainwater collection involves using tested and proven products to make quality rainwater available for use in and around your property. You don't need much to get started and you will be surprised how easy it is to get the most out of your rainwater system.

[How can we help you?](#)

COMPLIANCE

AS/NZS 4020:2005 – Testing of products for use in contact with drinking water

DISCLAIMER This product specification is not a complete guide to product usage. Further information is available from Rain Harvesting Pty Ltd and from the Installation and Operating Instructions. This specification sheet must be read in conjunction with the Installation and Operating Instructions and all applicable statutory requirement. Product specifications may change without notice. © Rain Harvesting Pty Ltd

RAIN HARVESTING

by Blue Mountain Co

For more information or to find out
how we can help, just give us a call on

+61 7 3248 9600

Or visit our website at

rainharvesting.com